

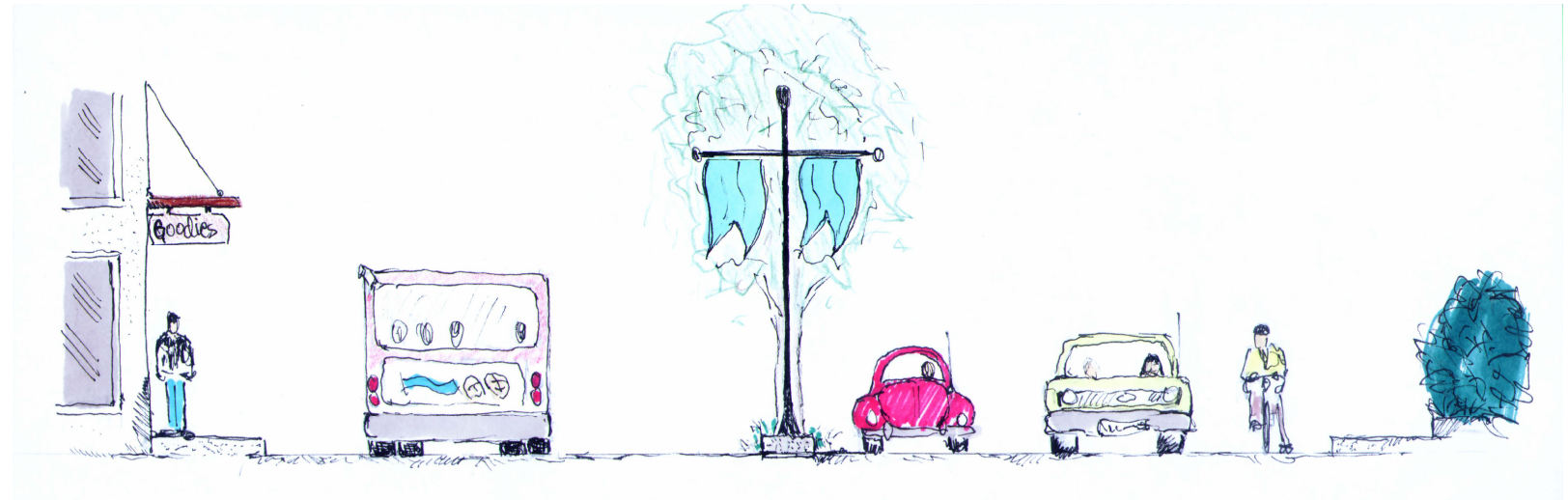

TILLICUM RD

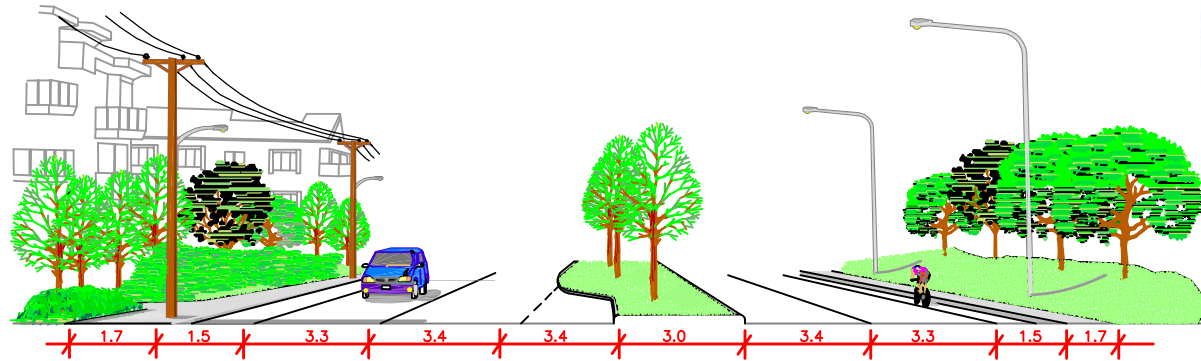

SECTION A



SECTION B

\* NOTE: ALL LANDSCAPED AREAS TO BE SUPPLIED WITH WATER CONNECTIONS AND POWER FOR IRRIGATION.

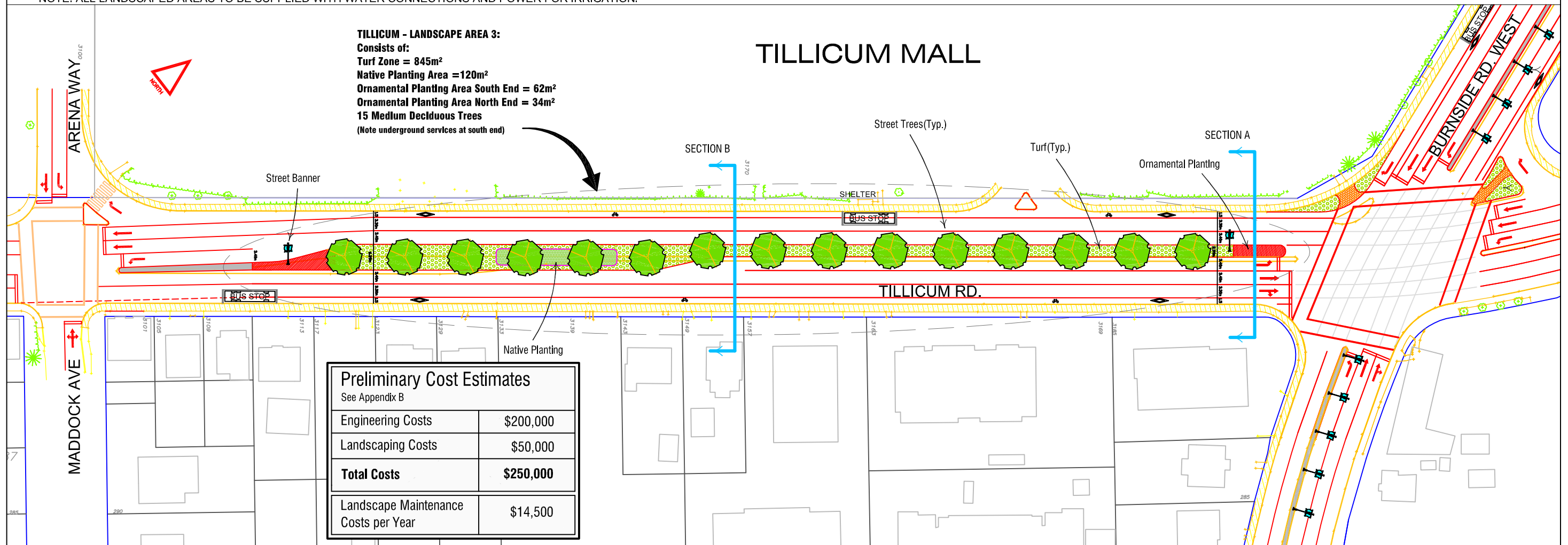

Preliminary Cost Estimates	
See Appendix B	
Engineering Costs	\$200,000
Landscaping Costs	\$50,000
<b>Total Costs</b>	<b>\$250,000</b>
Landscape Maintenance Costs per Year	\$14,500