

MATERIALS LEGEND

- CON1 ARCHITECTURAL CONCRETE
- CTP1 FIBRE REINFORCED CONCRETE PANEL (LIGHT GREY)
- GL1 DOUBLE GLAZED WINDOWS
- GL2 DOUBLE GLAZED CURTAIN WALL
- GL3 GLASS BALUSTRADE
- FC1 FIBER CEMENT CLADDING WHITE
- MC1 METAL CLADDING (CHARCOAL)
- MC2 METAL CLADDING (CHARCOAL)
- WD1 WOOD FINISH CLADDING
- MET1 METAL SCREENED ENCLOSURE

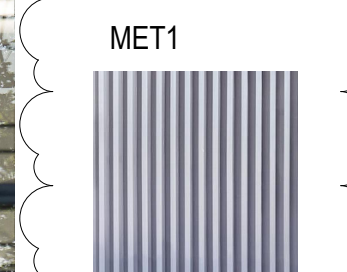
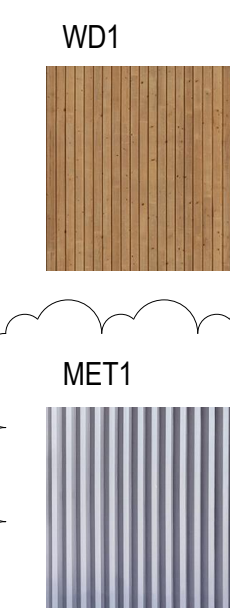
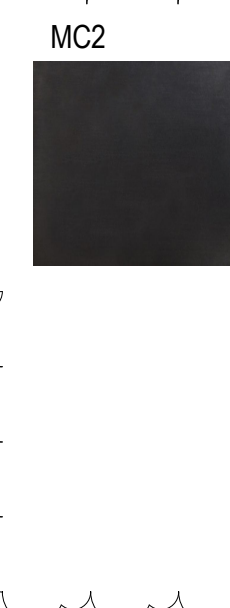
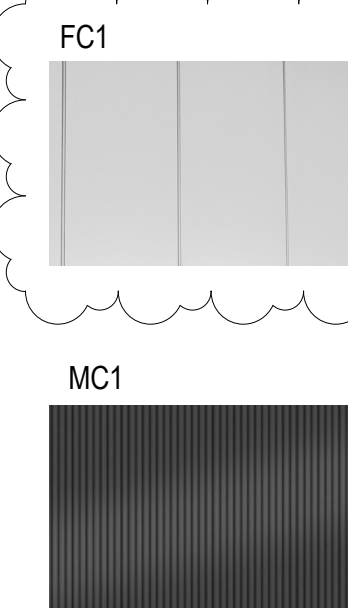
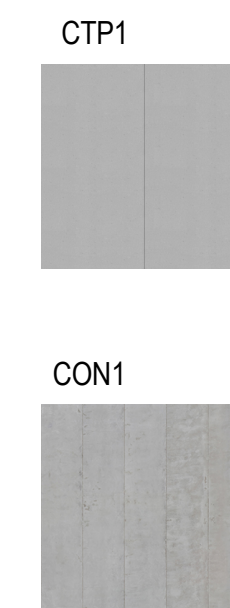

1 Building Elevation North
A200 1:100

EXTENT OF PARKING SHOWN DASHED

2023-04-21 11:40:32 AM

omb office of mcfarlane biggar
architects + designers
301-1825 Quebec Street Vancouver BC, Canada V5T 2Z3
T 604 558 6344 E info@officeomb.ca officeomb.ca

ARYZE TELUS living

© 2022 omb all rights reserved. The documents and design as an instrument of service are and at all times remain the exclusive property of omb. All designs and related information in whole or in part shown on these documents are for the express use for the specified project only and may not be reproduced without the express written consent of omb. Dimensions may not be scaled from the documents; drawing scale may be affected by printing, scanning or copying. omb shall not be held responsible for the accuracy or completeness of any existing information shown herein. Any person using this drawing shall be responsible for verifying all existing dimensions and conditions on site. This drawing to be read in conjunction with the Contract Documents.

DATE	REV	DESCRIPTION
1	06/28/2022	ISSUED FOR REZONING/DP
2	02/21/2023	ISSUED FOR REZONING/DP COORD
5	04/21/2023	ISSUED FOR RZ/DP RESUBMISSION



Telus Living
1805 Feltham
1805-1811 Feltham Rd, Saanich, BC
2021-019
[NOT FOR CONSTRUCTION]

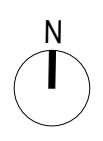

ELEVATION - NORTH
As indicated

A200

N
KEY PLAN

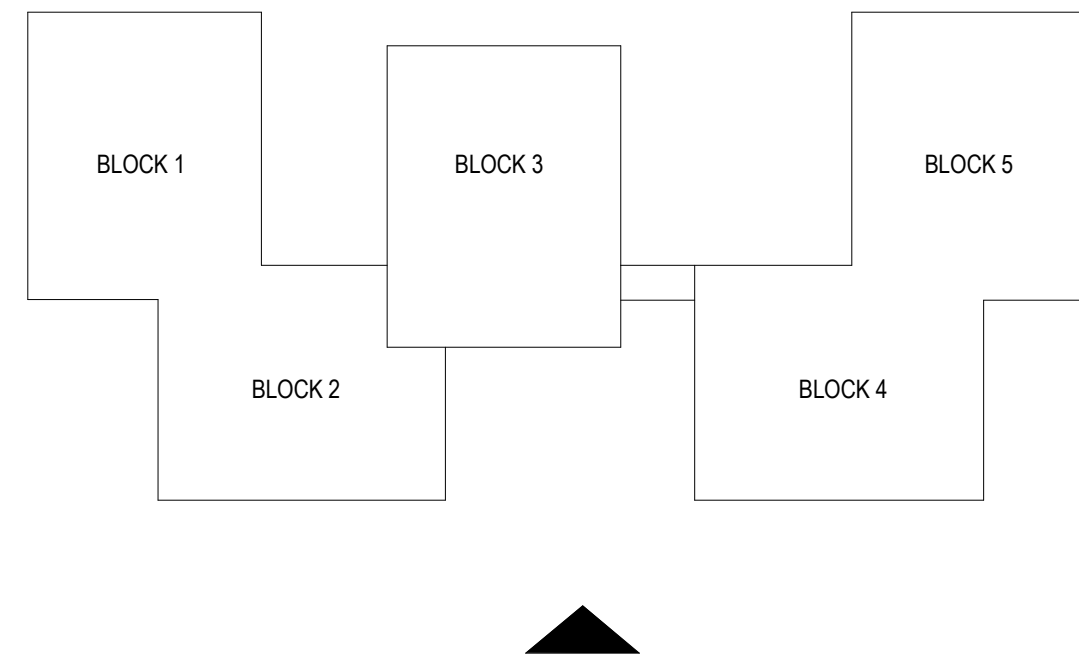

MATERIALS LEGEND

- CON1 ARCHITECTURAL CONCRETE
- CTP1 FIBRE REINFORCED CONCRETE PANEL (LIGHT GREY)
- GL1 DOUBLE GLAZED WINDOWS
- GL2 DOUBLE GLAZED CURTAIN WALL
- GL3 GLASS BALUSTRADE
- FC1 FIBER CEMENT CLADDING WHITE
- MC1 METAL CLADDING (CHARCOAL)
- MC2 METAL CLADDING (CHARCOAL)
- WD1 WOOD FINISH CLADDING
- MET1 METAL SCREENED ENCLOSURE

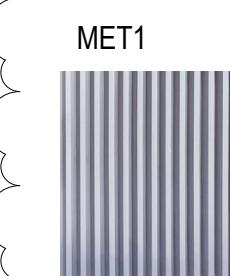
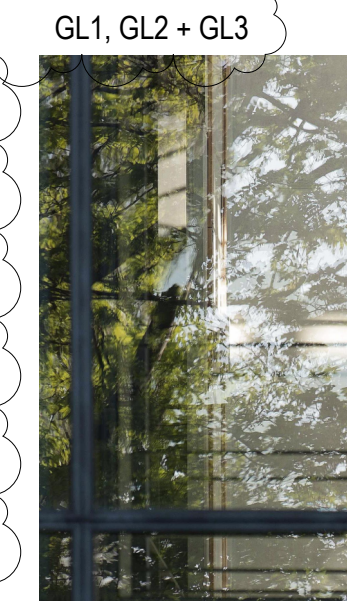
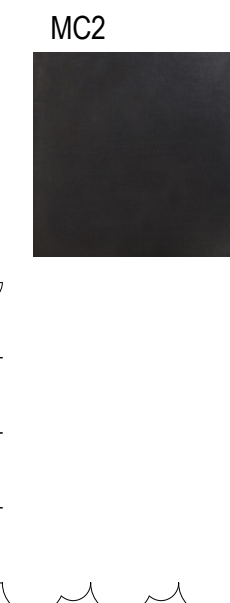
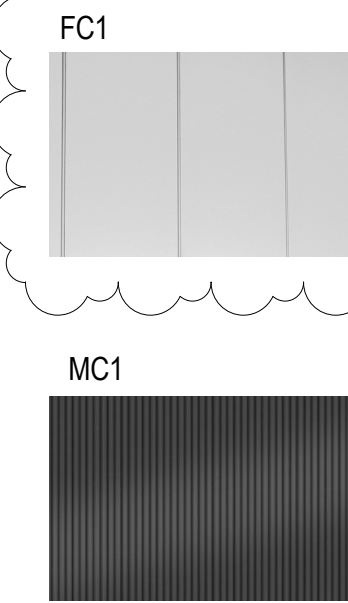
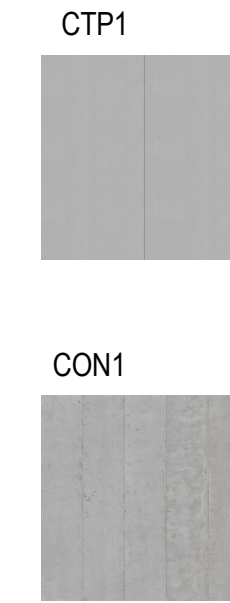

1 Building Elevation South
A201 1:100

2023-04-21 11:40:42 AM

omb office of mcfarlane biggar
architects + designers
301-1825 Quebec Street Vancouver BC, Canada V5T 2Z3
T 604 558 6344 E info@officeomb.ca officeomb.ca

ARYZE TELUS living

© 2022 omb all rights reserved. The documents and design as an instrument of service are and at all times remain the exclusive property of omb. All designs and related information in whole or in part shown on these documents are for the express use for the specified project only and may not be reproduced without the express written consent of omb. Dimensions may not be scaled from the documents; drawing scale may be affected by printing, scanning or copying. omb shall not be held responsible for the accuracy or completeness of any existing information shown herein. Any person using this drawing shall be responsible for verifying all existing dimensions and conditions on site. This drawing to be read in conjunction with the Contract Documents.

DATE	REV	DESCRIPTION
1	06/28/2022	ISSUED FOR REZONING/DP
2	02/21/2023	ISSUED FOR REZONING/DP COORD
5	04/21/2023	ISSUED FOR RZ/DP RESUBMISSION



Telus Living
1805 Feltham
1805-1811 Feltham Rd, Saanich, BC
2021-019
[NOT FOR CONSTRUCTION]



ELEVATION - SOUTH
As indicated

A201

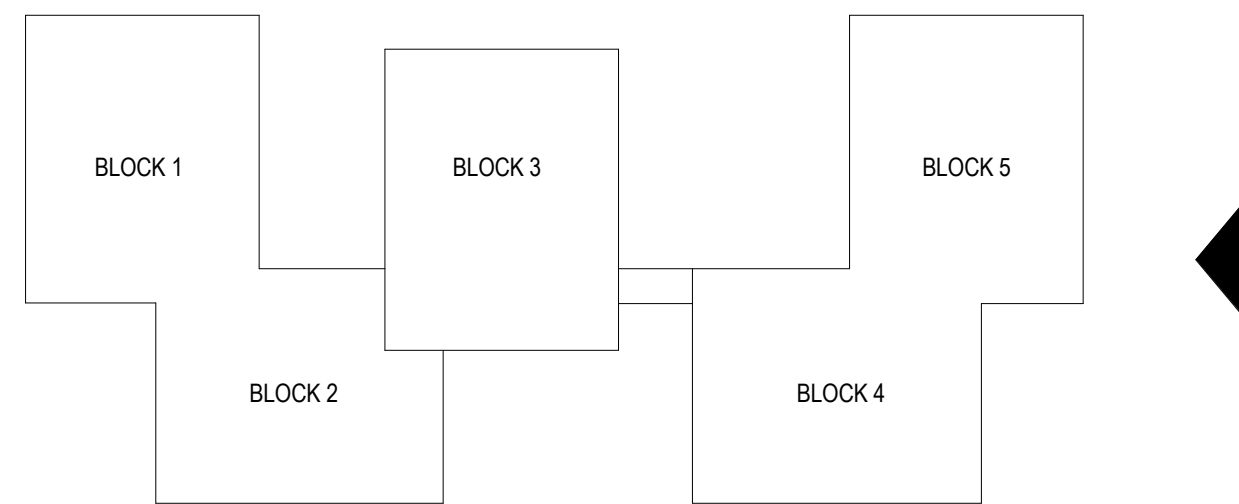
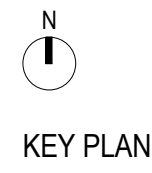

MATERIALS LEGEND

- CON1 ARCHITECTURAL-CONCRETE
- CTP1 FIBRE REINFORCED CONCRETE PANEL (LIGHT GREY)
- GL1 DOUBLE GLAZED WINDOWS
- GL2 DOUBLE GLAZED CURTAIN WALL
- GL3 GLASS BALUSTRADE
- FC1 FIBER CEMENT CLADDING WHITE
- MC1 METAL CLADDING (CHARCOAL)
- MC2 METAL CLADDING (CHARCOAL)
- WD1 WOOD FINISH CLADDING
- MET1 METAL SCREENED ENCLOSURE

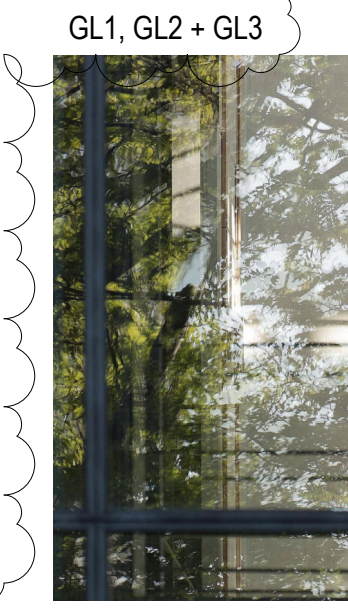
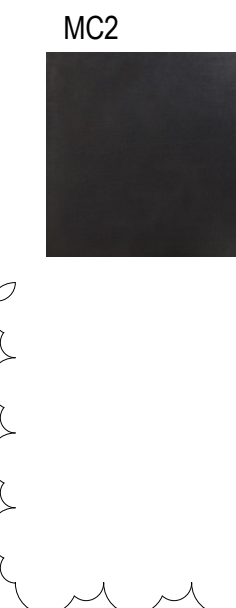
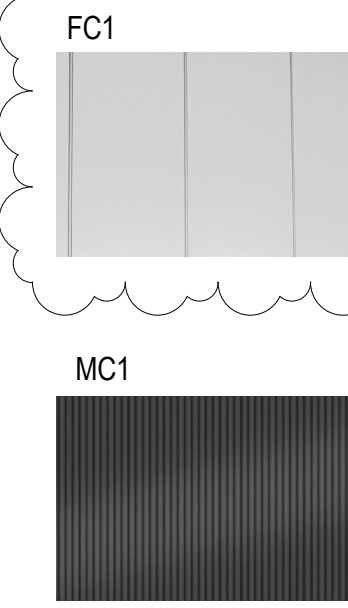
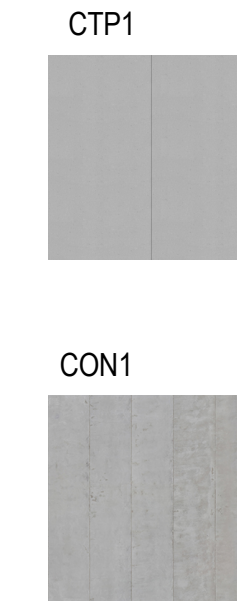

1 Building Elevation East
A202 1:100

RECEIVED
APR 26 2023
PLANNING DEPT.
DISTRICT OF SAANICH

2023-04-21 11:40:48 AM

omb office of mcfarlane biggar
architects + designers
301-1825 Quebec Street Vancouver BC, Canada V5T 2Z9
T 604 558 6344 E info@officeomb.ca officeomb.ca

ARYZE TELUS living

© 2022 omb all rights reserved. The documents and design as an instrument of service are and at all times remain the exclusive property of omb. All designs and related information in whole or in part shown on these documents are for the express use for the specified project only and may not be reproduced without the express written consent of omb. Dimensions may not be scaled from the documents; drawing scale may be affected by printing, scanning or copying. omb shall not be held responsible for the accuracy or completeness of any existing information shown herein. Any person using this drawing shall be responsible for verifying all existing dimensions and conditions on site. This drawing to be read in conjunction with the Contract Documents.

DATE	REV	DESCRIPTION
1	06/28/2022	ISSUED FOR REZONING/DP
2	02/21/2023	ISSUED FOR REZONING/DP COORD
5	04/21/2023	ISSUED FOR RZ/DP RESUBMISSION



Telus Living
1805 Feltham
1805-1811 Feltham Rd, Saanich, BC
2021-019
[NOT FOR CONSTRUCTION]

ELEVATION - EAST
As indicated

A202

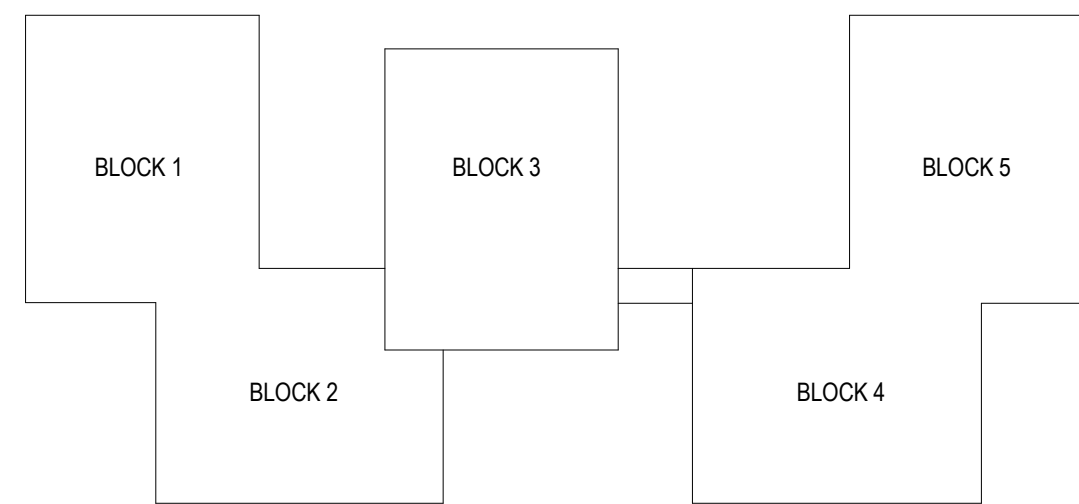

MATERIALS LEGEND

- CON1 ARCHITECTURAL CONCRETE
- CTP1 FIBRE REINFORCED CONCRETE PANEL (LIGHT GREY)
- GL1 DOUBLE GLAZED WINDOWS
- GL2 DOUBLE GLAZED CURTAIN WALL
- GL3 GLASS BALUSTRADE
- FC1 FIBER CEMENT CLADDING WHITE
- MC1 METAL CLADDING (CHARCOAL)
- MC2 METAL CLADDING (CHARCOAL)
- WD1 WOOD FINISH CLADDING
- MET1 METAL SCREENED ENCLOSURE

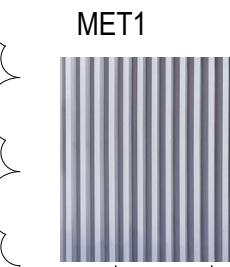
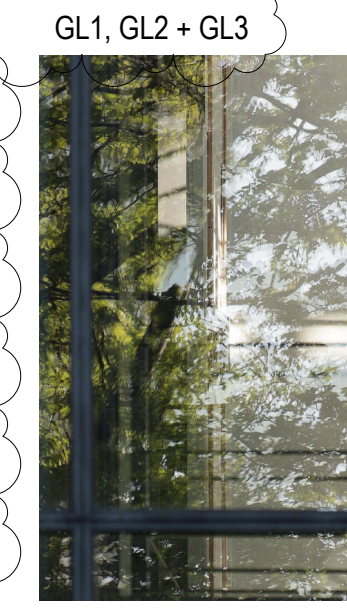
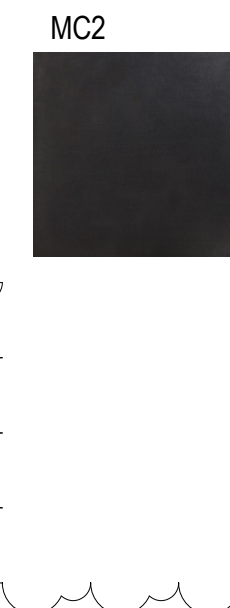
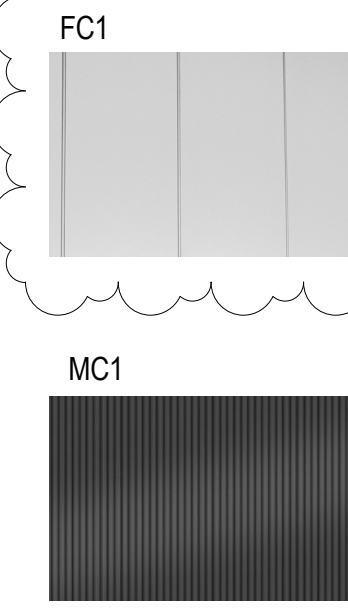
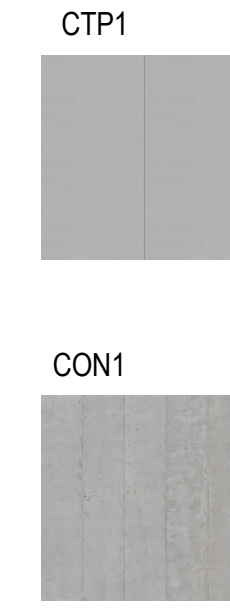

1 Building Elevation West
A203 1:100

RECEIVED
APR 26 2023
PLANNING DEPT.
DISTRICT OF SAANICH

2023-04-21 11:40:54 AM

omb office of mcfarlane biggar
architects + designers
301-1825 Quebec Street Vancouver BC, Canada V5T 2Z9
T 604 558 6344 E info@officeomb.ca officeomb.ca

ARYZE TELUS living

© 2022 omb all rights reserved. The documents and design as an instrument of service are and at all times remain the exclusive property of omb. All designs and related information in whole or in part shown on these documents are for the express use for the specified project only and may not be reproduced without the express written consent of omb. Dimensions may not be scaled from the documents; drawing scale may be affected by printing, scanning or copying. omb shall not be held responsible for the accuracy or completeness of any existing information shown herein. Any person using this drawing shall be responsible for verifying all existing dimensions and conditions on site. This drawing to be read in conjunction with the Contract Documents.

DATE	REV	DESCRIPTION
1	06/28/2022	ISSUED FOR REZONING/DP
2	02/21/2023	ISSUED FOR REZONING/DP COORD
5	04/21/2023	ISSUED FOR RZ/DP RESUBMISSION



Telus Living
1805 Feltham
1805-1811 Feltham Rd, Saanich, BC
2021-019
[NOT FOR CONSTRUCTION]

ELEVATION - WEST
As indicated

A203