



CONCRETE SITWALL LIGHTING
LINEAR LED LIGHTING



BLOCK WALL LIGHTING
STYLE TO BE DETERMINED



CORA EXP APPROVED POWDER TO BE DET BIKE RACK

LEGEND

- PROPERTY LINES
- LINE OF UNDERGROUND PARKADE
- BRUSH FINISH CONCRETE WALKWAYS - REFER TO CIVIL DWGS
- DECORATIVE PAVING EXPOSED AGGREGATE, STAMPED CONCRETE OR UNIT PAVING TBD
- DRAIN ROCK 200 MM DEPTH 2" - 4" DIM WASHED COBBLE ROCK ON FILTER FABRIC CW PT WOOD EDGER
- LAWN = 500 ON 150 MM MIN DEPTH APPROVED GROWING MEDIUM
- PLANTING BED CW 50 MM DEPTH OF BARK MULCH GROUND COVER ON APPROVED FILTER FABRIC ON APPROVED GROWING MEDIUM 450 MM MIN DEPTH FOR SHRUBS 700 MM MIN FOR TREES
- 1 METER DIA. MULCH RING - FOR ALL TREES IN LAWN
- FRONT ENTRY YARD FENCING - STYLE & STAIN COLOUR TBD - 4' HEIGHT TYP.
- PT WOOD PRIVACY FENCE - STYLE & STAIN COLOUR TBD - 6' HEIGHT TYP.
- PT 4x4 WOOD EDGER TO SEPARATE PLANTING FROM LAWN
- LINEAR LED LIGHTING
- WALL & STEP LIGHTING (STYLE TO BE DETERMINED)
- BENCH COMPOSITE PLASTIC & METAL SKYLINE BY WISBONE OR APPROVED EQUAL
- CORA BIKE RACK SECURED TO CONCRETE WALKWAY
- METAL BIKE RACK HOOP STYLE SECURED TO CONCRETE WALKWAY
- TIERED PRECAST BLOCK RETAINING WALLS/PLANTERS
- METAL POWDER COATED PAINTED PLANTER EDGES MIN 500mm HT FOR PLANTING BEDS OVER SLAB VARIOUS SHAPES & SIZES AS SHOWN

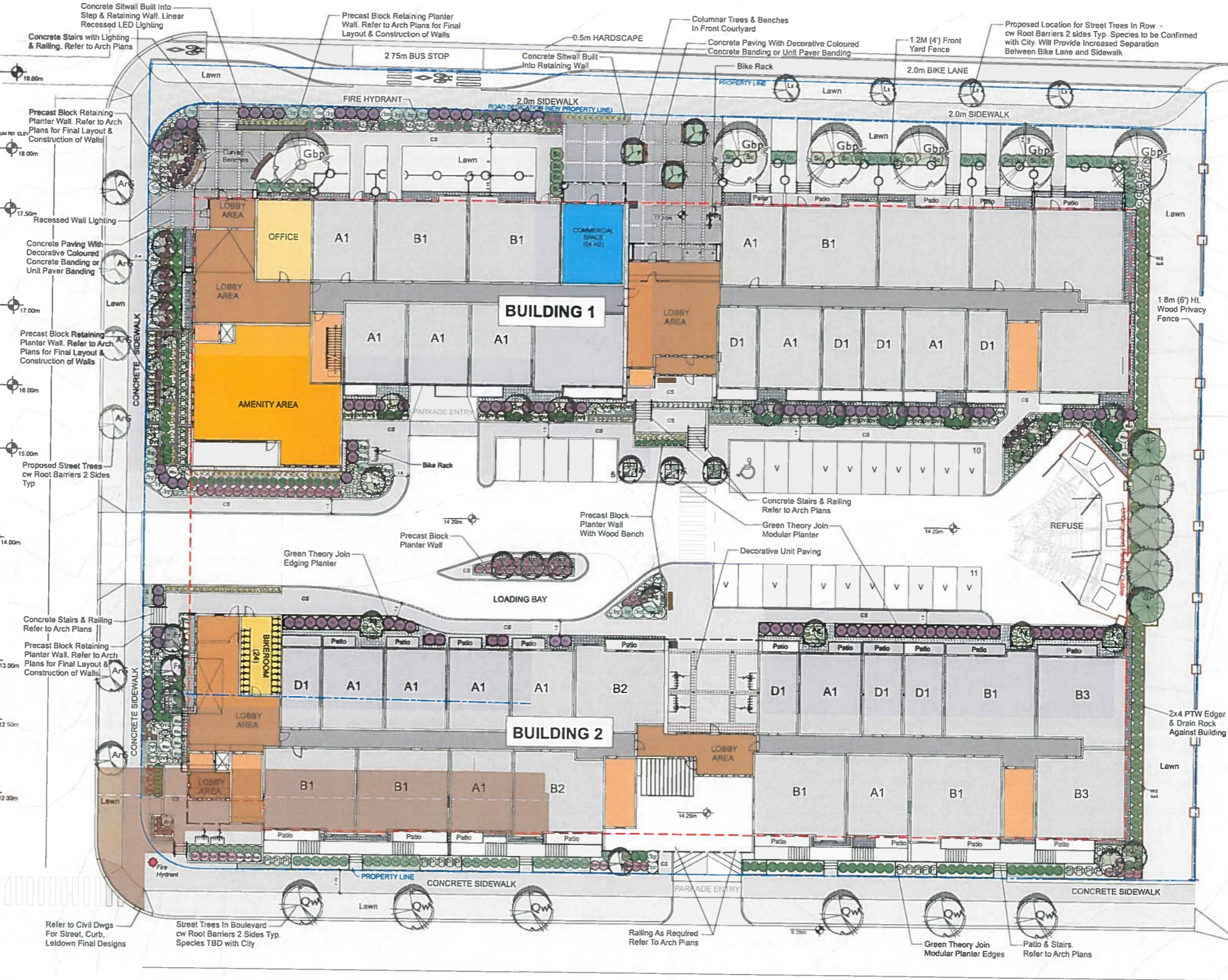

ONSITE PLANT LIST

| SYMBOL | BOTANICAL NAME | COMMON NAME | COUNT | SIZE |
|---------------|---|---|-------|----------|
| Trees | | | | |
| As | Acer spicatum | Spacerbark Maple | 5 | 5cm Cal. |
| Cn | Cornus nuttallii 'Eddie's White Wonder' | Pacific Dogwood Eddie's White Wonder (multi-stem) | 8 | 5cm Cal. |
| Gb | Ginkgo biloba 'Prince of Peace' | Princeton Sentry Ginkgo | 7 | 6cm Cal. |
| M | Magnolia 'Sunshine' | Sunshine Magnolia | 6 | 5cm Cal. |
| SP | Pinus contorta | Shore Pine | 2 | 2m |
| Pc | Pinus contorta | Shore Pine | 17 | 2.5m |
| Fa | Fagus sylvatica 'Dawson's Purple' | Dawson's Purple Beech | 6 | 6cm Cal. |
| AC | Abies concolor | White Fir | 3 | 2m |
| PaA | Prunus serrulata 'Amanogawa' | Amanogawa Flowering Cherry | 9 | 5cm Cal. |
| Shrubs | | | | |
| AzA | Azalea japonica 'Alaska' | Alaska Azalea | 8 | #2pot |
| bb | Buxus 'Green Velvet' | Green Velvet Boxwood | 8 | #2pot |
| jd | Juniperus horizontalis 'Blue Prince' | Blue Prince Juniper | 36 | #2pot |

| SYMBOL | BOTANICAL NAME | COMMON NAME | COUNT | SIZE |
|--|--|---------------------------------|-------|----------|
| AbN | Abies balsamea 'Nana' | Dwarf Balsam Fir | 34 | #2pot |
| Og | Malvastrum coccineum | Tall Oregon Grape | 47 | #2pot |
| Pt | Prunus laurocerasus 'Otto Luyken' | Otto Luyken English Laurel | 35 | #2pot |
| Pa | Pinus japonica 'Katsura' | Katsura Japanese Pine | 37 | #2pot |
| Pm | Pinus mugo pumila | Dwarf Mugo Pine | 14 | #5pot |
| nr | Philadelphus x virginialis 'Dwarf Snowflake' | Miniature Snowflake Mock Orange | 87 | #2pot |
| Rv | Rhododendron x 'Ramapo' | Ramapo Rhododendron | 115 | #2pot |
| Rhc | Rhododendron x 'Dunningham' | Cunningham Rhododendron | 34 | #2pot |
| Sc | Sarcococca confusa | Sweet Box | 81 | #2pot |
| Sdr | Spiraea 'Doris Red' | Doris Red Spirea | 81 | #2pot |
| Vd | Viburnum davidii | David Viburnum | 88 | #2pot |
| Ornamental Grasses, Vines & Groundcover | | | | |
| Ck | Calamagrostis x acutiflora 'Karl Foerster' | Feather Reed Grass | 96 | #1pot |
| Dc | Deschampsia cespitosa 'Goldtau' | Goldtau Tufted Hairgrass | 111 | #1pot |
| H | Helictotrichon sempervirens | Blue Oat Grass | 44 | #1pot |
| Hm | Hakonechloa macro 'Aureola' | Japanese Forest Grass | 53 | #1pot |
| Ph | Pennisetum alopecuroides 'Hemeln' | Dwarf Fountain Grass | 62 | #1pot |
| k | Arcostaphylos uva-ursi | Kinnikinnick | 12 | 10cm pot |
| Perennials | | | | |
| b | Heuchera micrantha 'Bressingham Bronze' | Bressingham Bronze Coral Bells | 25 | #1pot |
| Htd | Hosta 'Fragrant Dream' | Fragrant Dream Hosta | 7 | #1pot |
| Hh | Hamamelis hybrid | Dwarf Hybrid | 9 | #1pot |
| sl | Polystichum multifidum | Sweet Fern | 0 | #1pot |
| Lf | Althya filifemina | Lady Fern | 4 | #1pot |

OFFSITE PROPOSED TREE LIST (FOR REVIEW AND COMMENT)

| SYMBOL | BOTANICAL NAME | COMMON NAME | COUNT | SIZE |
|--------------|--|-----------------------------|-------|----------|
| Trees | | | | |
| ArG | Acer rubrum 'Armstrong Gold' | Armstrong Gold Maple | 6 | 6cm Cal. |
| Lg | Ligustrum sinense 'Sander-Silberstein' | Golden Silverleaf Ligustrum | 4 | 6cm Cal. |
| Or | Ornithoglossum 'Regal Prince' | Regal Prince Ornithoglossum | 8 | 6cm Cal. |



ALL WORK AND MATERIALS SHALL BE TO CANADIAN LANDSCAPE STANDARDS

| Date | Revisions | By |
|------------|------------------------------|-------|
| 04 06 2021 | Draft For Review | LS/SD |
| 04 18 2021 | For DP Review | LS |
| 08 07 2021 | Landscape Revisions | LS/SD |
| 08 10 2021 | Landscape Revisions | LS |
| 06 25 2022 | Revised to Shifted Buildings | LS |
| 06 28 2022 | Release For DP | LS |

LAZZARIN SVISDAHL
LANDSCAPE ARCHITECTS
203-1300 1st Avenue, Prince George B.C. V2V 2Y3
250-563-6158 www.lsls-landsc.com

Project
IRONCLAD DEVELOPMENTS
TILlicUM
VICTORIA, BC

Sheet Title
Landscape Plan

Date April 6, 2021
Scale 1:300 METERS
Drawn By SD
Project No.

Copyright reserved. This drawing and the design are, and at all times remain the exclusive property of Lazzarin Svisdahl Landscape Architects and cannot be used without the Landscape Architect's written consent.

Drawing No.

L1