

Proposed Subdivision Plan Of: Strata Lot F, Section 79, Victoria District, Plan EPS4264

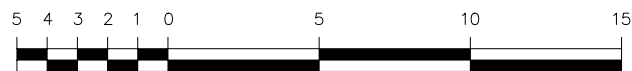
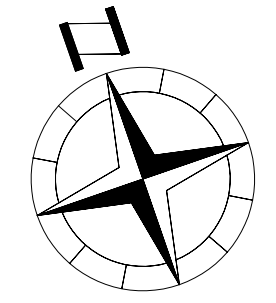

Scale = 1:250

Dated this 3rd day of June, 2022.

Distances and elevations shown are in metres.

Elevations are geodetic.

Legend:

- Denotes Tree
- #851 Denotes Tag Number
- ENSCA Denotes Existing Natural State Covenant Area

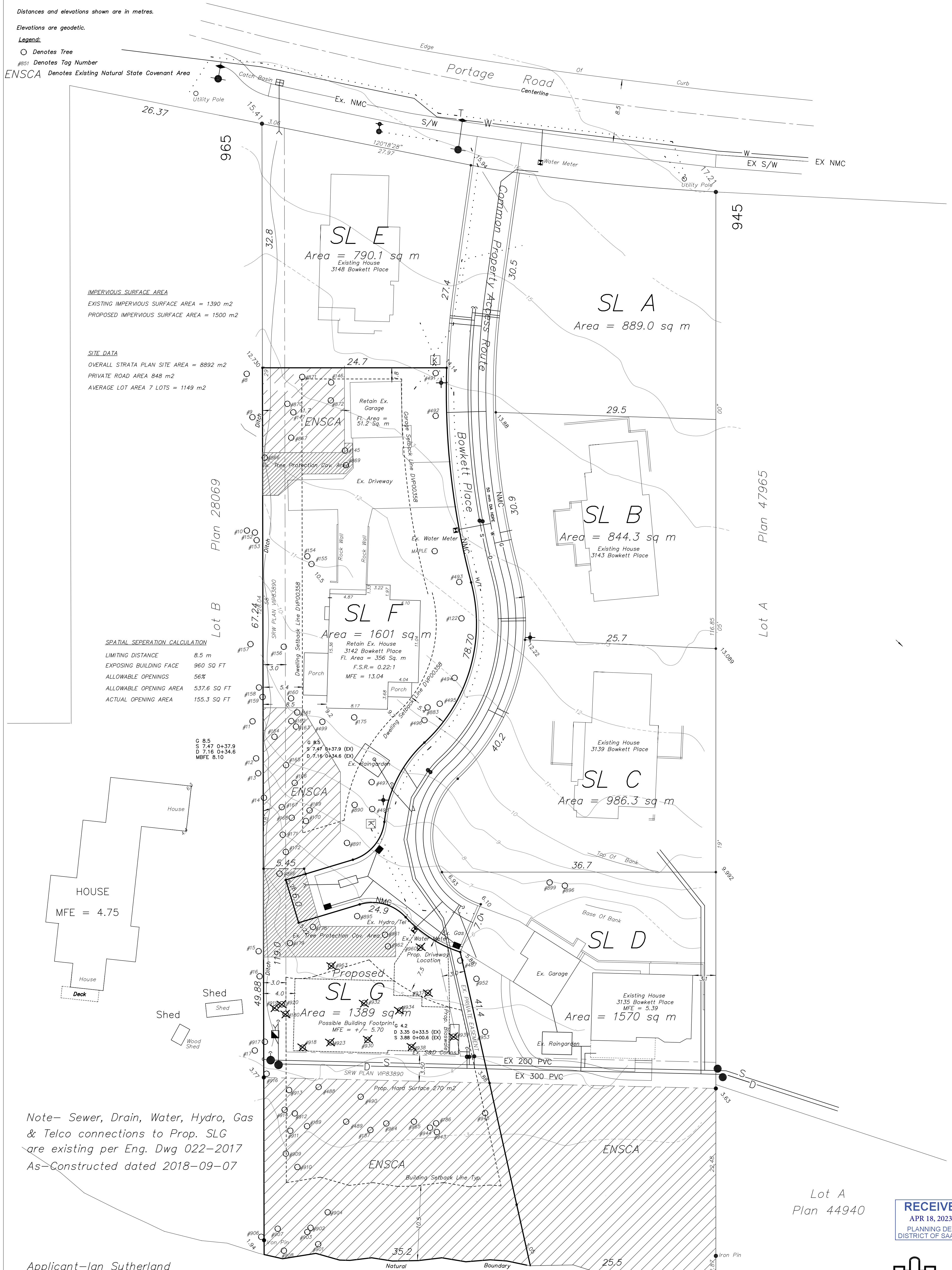

Note- Sewer, Drain, Water, Hydro, Gas & Telco connections to Prop. SLG are existing per Eng. Dwg 022-2017 As-Constructed dated 2018-09-07

Applicant-Ian Sutherland
Property Owner-Ian Sutherland/Brian Guy
Civic Address-3142 Bowkett Place
Designer-Ian Sutherland
Engineer-City Engineering Inc.
Surveyor-Wey Mayenburg Land Surveying Inc.

Note - For Trees Noted on this Plan. Refer to Talbot MacKenzie June 13, 2022 Inventory for Species, Caliper, PRZ and CRZ

RECEIVED
APR 18, 2023
PLANNING DEPT.
DISTRICT OF SAANICH

city engineering inc.
engineered solutions
project management
1715 government st. victoria bc v8w 1z4
p.250.661.3101 john@cityeng.ca

Wey Mayenburg Land Surveying Inc.
www.weysurveys.com
#4-2227 James White Boulevard
Sidney, BC V8L 1Z5
Telephone (250) 656-5155
File: 120280/Top/MS